

PO Box 730 • #1 Town & Country Square • White Salmon, Washington 98672 • 509-493-3323 • fax 509-493-2229
www.gorgecommission.org

COLUMBIA RIVER GORGE COMMISSION

RE-NOTICE OF DEVELOPMENT REVIEW

This notice serves as an opportunity to comment on the application described below.

- Proposal:** The Columbia River Gorge Commission has received an application from Charles Guthrie and Cheryl Park to remove an existing building; construct a 400 square foot addition to an additional existing building and convert the use to a winery building; construct a tasting room and winery storage building; and install deer fencing. The application also includes an after-the-fact review of a driveway.
- Location:** The subject parcel is located adjacent to the intersection of SR 141 and 141 Alt. Route in the SW 1/4 of Section 11, Township 3 North, Range 10 East, W.M., Klickitat County, Washington.
- Case File:** C11-0003
- Zoning:** The subject parcel is designated GMA Large-Scale Agriculture and is 5.76 acres in size.
- Comment Deadline:** The deadline for submitting public comment on the proposal is September 15, 2011.

The application and supporting documents are available for review at the Commission's office at #1 Town & Country Square (next to the White Salmon library), White Salmon, 8:00 a.m. to 5:00 p.m., Monday through Thursday, (509) 493-3323. Additional information is available on our website at www.gorgecommission.org under For Public Comment.

Comments may be mailed to the Commission's office, P.O. Box 730, White Salmon, WA 98672. Comments received are a matter of public record and are made available to the applicant. Comments may also be submitted by email to info@gorgecommission.org. This application will be reviewed for consistency with the applicable portions of the Land Use Ordinance adopted by the Columbia River Gorge Commission (Commission Rule 350-81). The application is also subject to review for consistency with the Columbia River Gorge National Scenic Area Act (P.L. 99-663) and Management Plan. Consistency with the National Scenic Area Act does not imply nor ensure compliance with all other applicable local, state, and federal laws.

The Executive Director is scheduled to make a decision on the request by August 27, 2011.
Please Note: On June 14, 2011, emergency rule 350-81-042 was approved by the Gorge Commission to allow reduced planning staff additional time to review applications for consistency when needed.

Executive Director

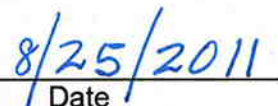
Date

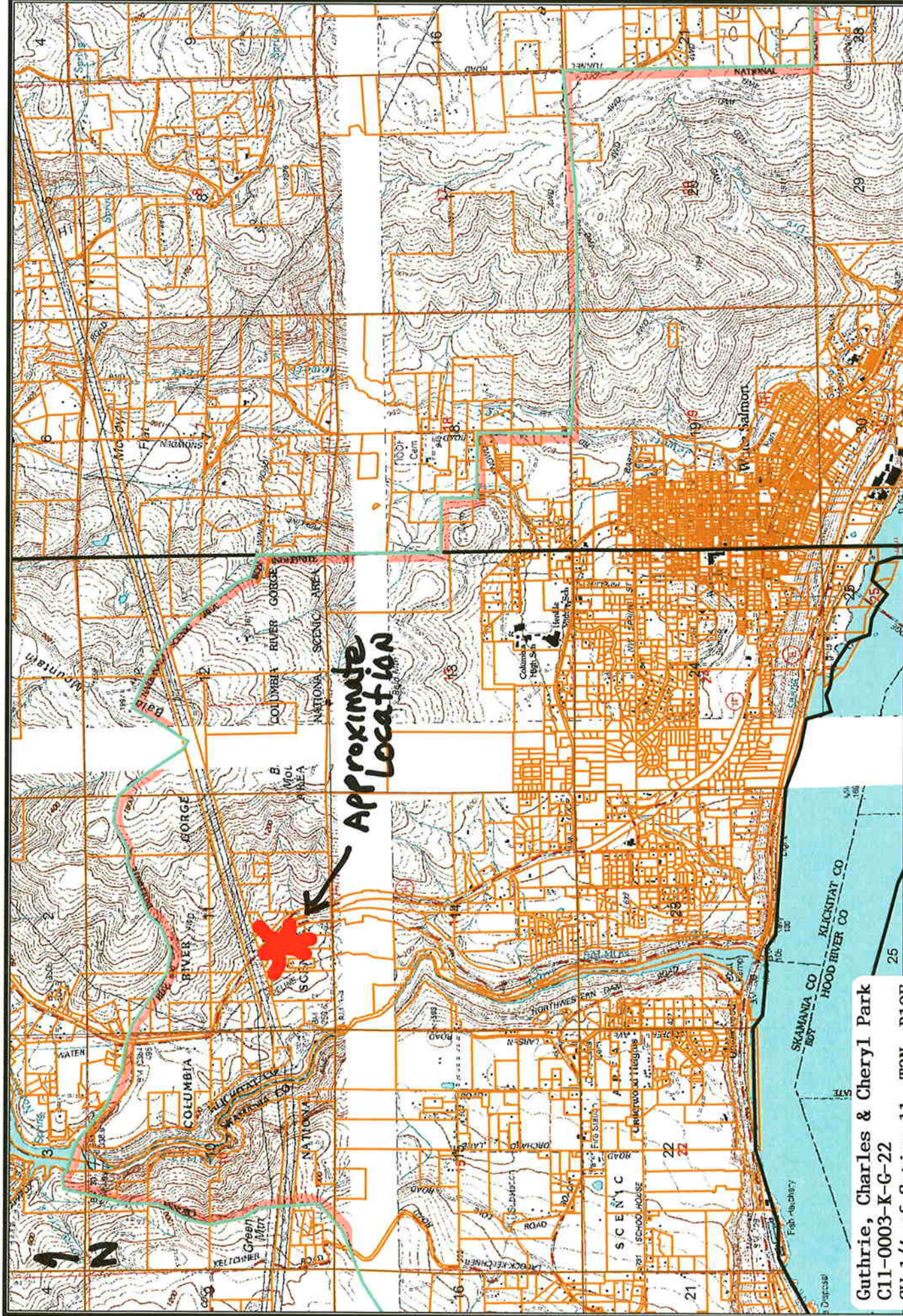

Approximate Location

Guthrie, Charles & Cheryl Park
C11-0003-K-G-22
SW 1/4 of Section 11, T3N, R10E

Created by:

Date:

10,000

5,000

15,000

Feet



Disclaimer: The Columbia River Gorge National Scenic Area Columbia River Gorge Commission data, information, and maps are provided "as is" without warranty or any representation of accuracy, timeliness or completeness. This information is intended for general planning purposes and is not intended for site specific planning or analysis. Original data was compiled from various sources and that all information should be verified with those sources. Spatial information may not meet National Map Accuracy Standards. The requestor acknowledges and accepts all limitations, including the fact that the data, information, and maps are dynamic and in a constant state of maintenance, correction and update.