

Columbia River Gorge Commission

#1 Town & Country Square • PO Box 730 • White Salmon WA 98672 • 509-325-3121

RECEIVED

Land Use Application

FEB - 8 2011

Applicant(s) FRED HEANY

Property Owner(s) COLUMBIA RIVER GORGE COMM.

Mailing Address P.O. Box 1400

Mailing Address SAME

WHITE SALMON, WA 98672

Phone H 509-493-4453 (VOIP - NOT RELIABLE)

Phone H 509-493-4453 (VOIP INTERNET) NOT RELIABLE

W/cell 541-490-0988 good

W/cell 541-490-0988 good

Location of property:

Township 3 NORTH Range 11 EAST Street Address 283 COURTNEY RD

Section & Qtr Section E 1/2 SW 1/4 SE 1/4 SEC 28 3N11E County KLUCKITAT

Tax Lot No(s). 03112800003100 Parcel Size (acres) 20 ACRES

Existing development and use of parcel RESIDENTIAL, AGRICULTURE - HAY, GRAZING, GARDEN, BED + BREAKFAST RECREATION, WOODLOT

Proposed use and/or development: ~~WEDDINGS, RECEPTIONS, SMALL SCALE GATHERINGS~~ Solar panel and underground pool

Use of Adjacent Parcels RESIDENTIAL, AGRICULTURE, WOOD LOT, RECREATION.

Signature of the property owner(s) indicates that the property owner(s) is/are aware that an application is being made on the subject property. Signature of the property owner(s) also authorizes the Gorge Commission or the Commission's designee(s) reasonable access to the site in order to evaluate the application.

Applicant(s) signature Fred Heany

date 2-8-2011

date

Property owner(s) signature

date

Fred Heany

date 2-8-2011

Application checklist: The following is required to complete your application.

- Application form completed and signed
- Project description
- Site plan
- Elevation drawings
- Key viewing areas checklist
- Names and addresses of adjacent property owners
- Any additional information as required

Project description: Describe your proposed project including details on all uses proposed; the size, height, color, and construction materials of all structures; and any other details which explain how your proposal meets the requirements of the Scenic Area Land Use Ordinance.

(AMB)

SEE ATTACHED (Attachments Summarized
by staff here:)

1.) Free standing solar panel measuring

64' L x 14' W x 9' H

- Blue / black material array
- requires concrete Footings
- dark Frame

2.) Renew of existing in-ground pool

- approximate length: 70'
- width varies from 10 to 20'
- depth varies from 2 to 5'
- Irregular shape, fed by artificial stream
- associated pool fence: 4-5' tall, semi solid rail

Note: solar panel will be used to heat pool, ~~and~~ requiring conduit to be placed. Requires approx. 30ft of conduit, trenched 3ft deep.

Please see applicant's materials for more info.

N SYMBOLS

SCALE 1" = 100'

GARDEN → G

STORAGE → S

FIR/PINE OAK TREES → [Symbol]

YA' AT' EEH B+B

~~WEDDING SITE PLAN~~ (AMB)

APPLICANT: FRED HEANY

SEE EXHIBIT A-1 TO A-4
ALL POWER UNDERGROUND

5' Pool Fence
REQUIRED BY COUNTY AND
FEDERAL CODE FOR SAFETY
BLACK VINYL COATED

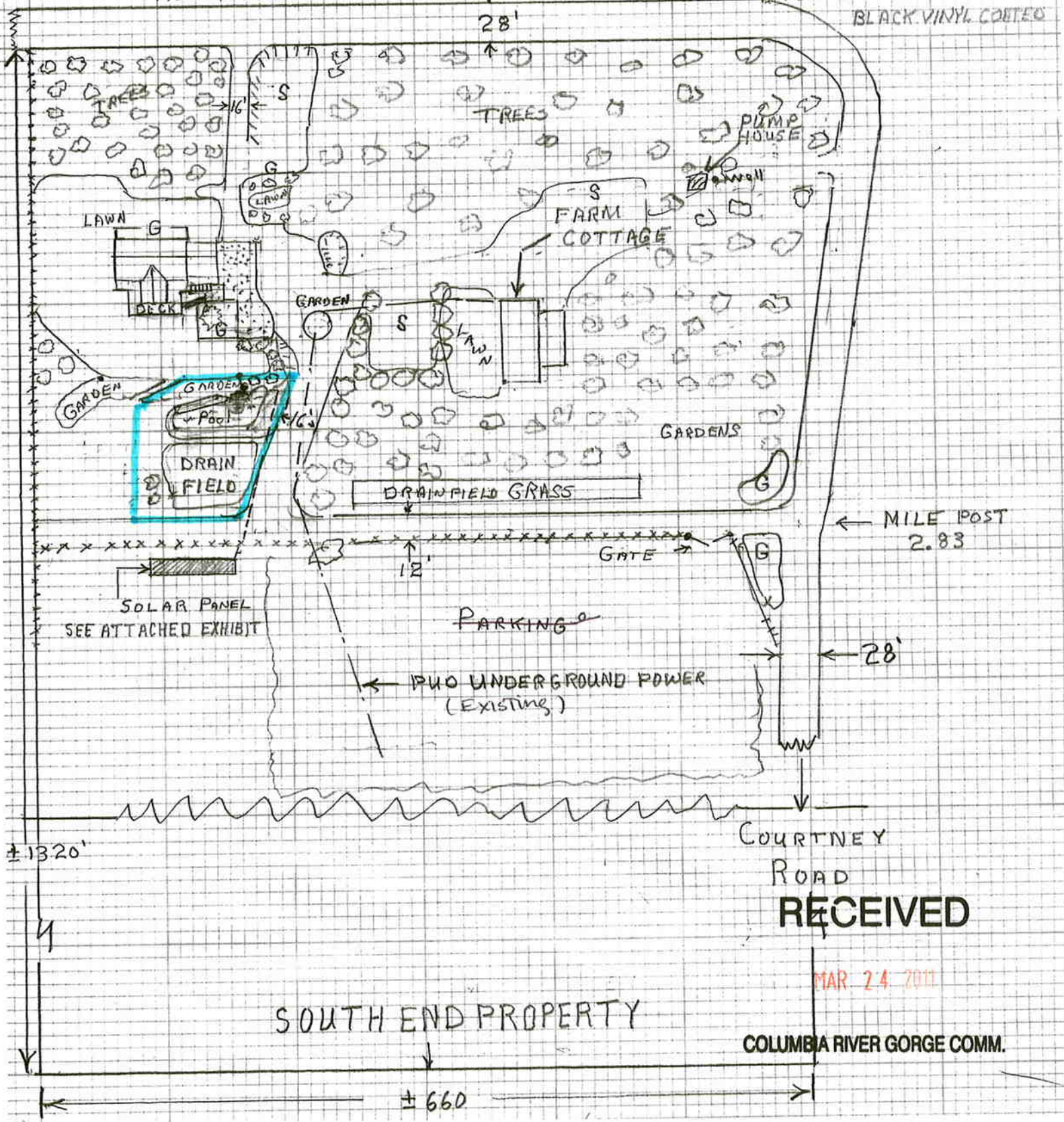

RECEIVED

MAR 24 2011

COLUMBIA RIVER GORGE COMM.

SOUTH END PROPERTY

± 660

± 1320'

RECEIVED

SOLAR PANEL
TO HEAT WATER

FEB - 8 2011

COLUMBIA RIVER GORGE COMM.

EXHIBIT A-1

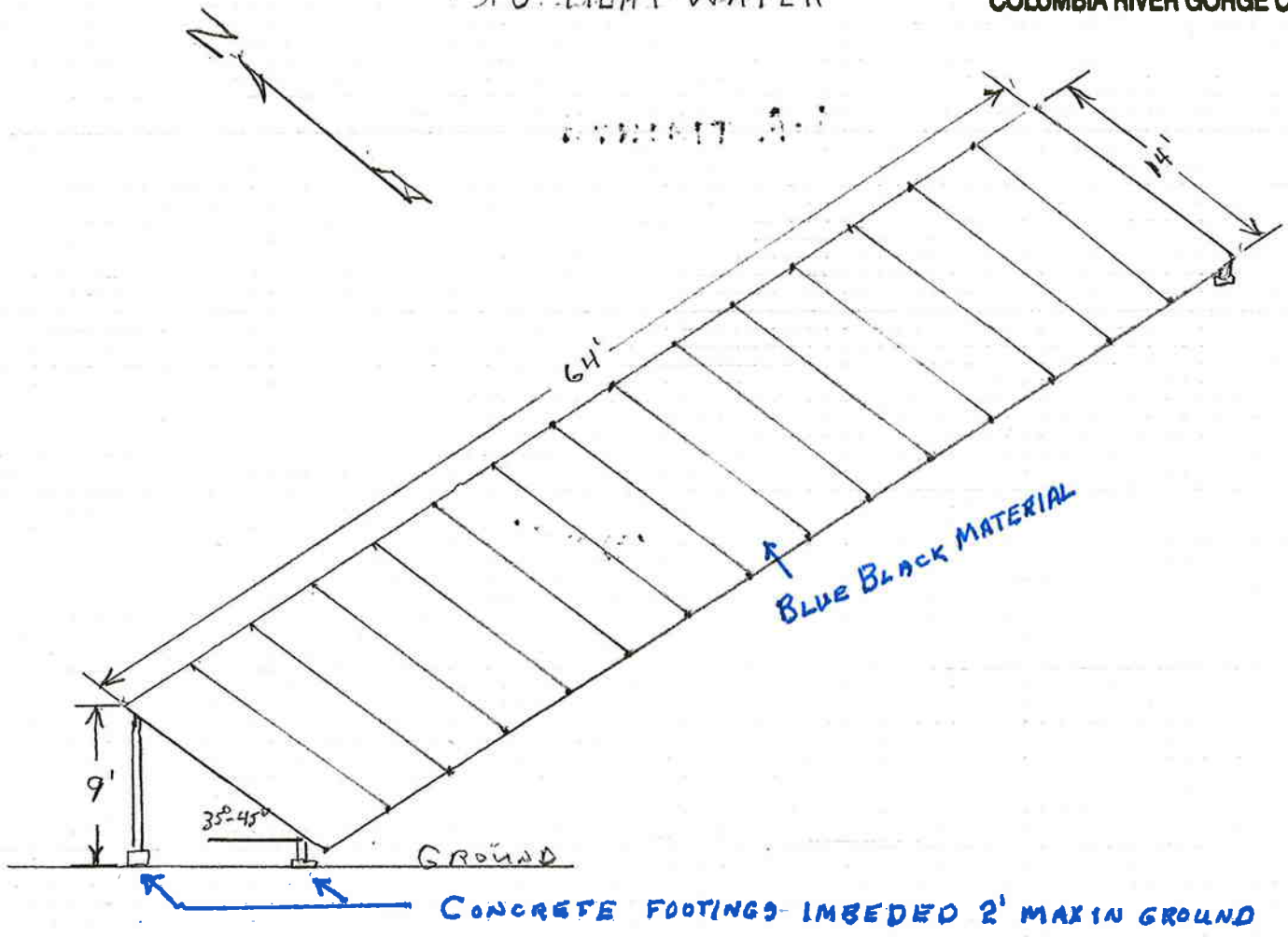



SCALE 1 INCH = 10 FT

SYMBOLS

- WF- WATERFALL
- P - POND
- S- SKIMMER
- L- SUNKEN LITE

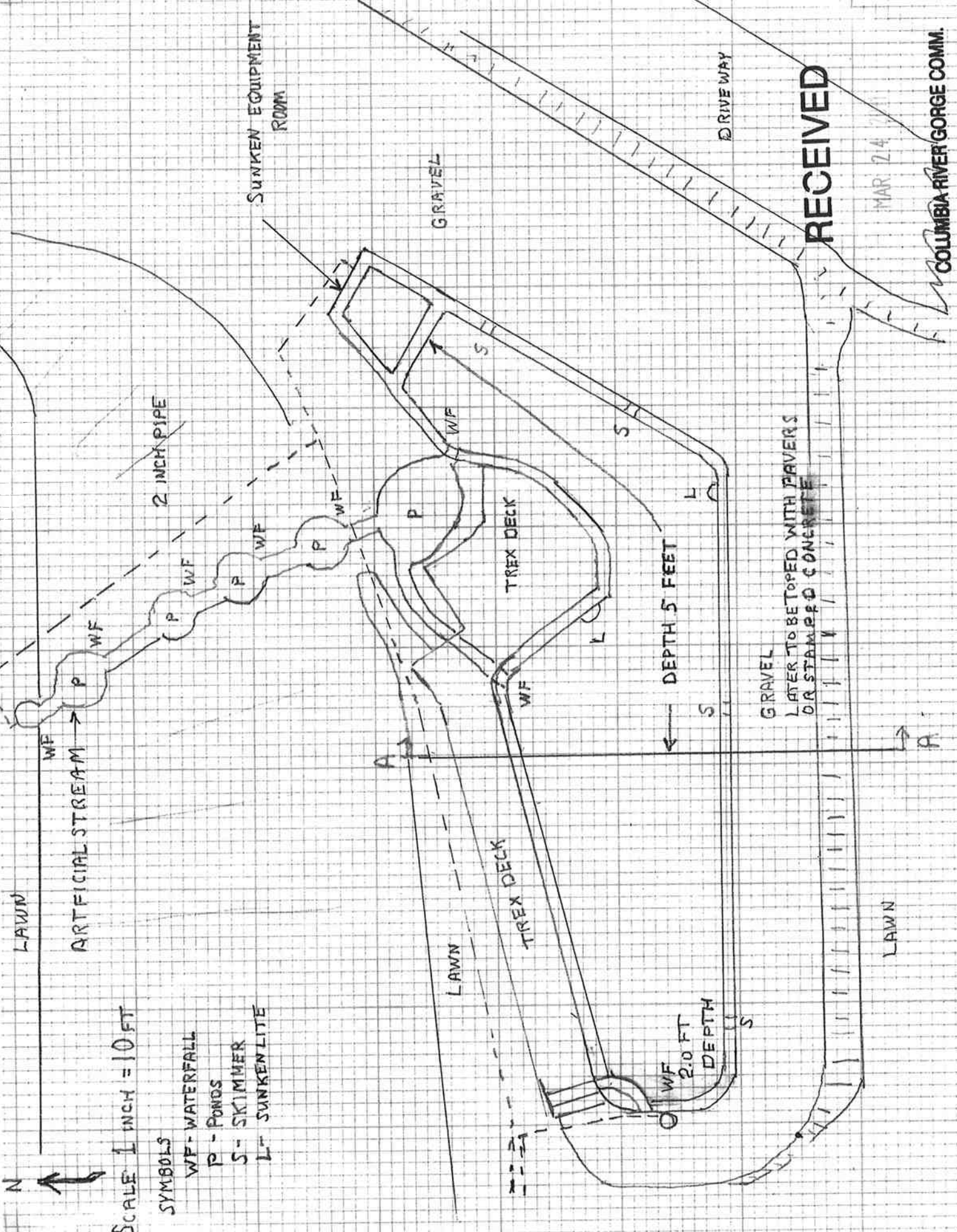

RECEIVED

MAR 24 2011

COLUMBIA RIVER GORGE COMM.

INGROUND POOL CROSS SECTION A-A

SCALE 1 INCH = 4 FEET

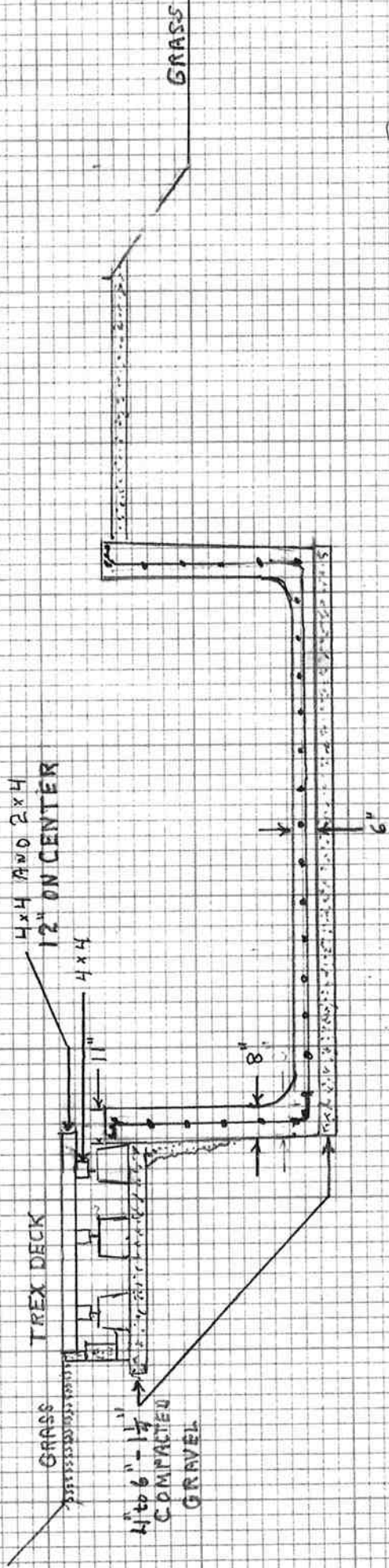

REBAR # 3 40000 PSI 12" ON CENTER FLOOR + SIDEWALL 3 - # 3 REBAR ON TOP
CONCRETE 8 SACK 4000 PSI SACRETE

RECEIVED

MAR 24 2011

COLUMBIA RIVER GORGE COMM.



48" tall at least
60" tall at max
~~54" tall at max~~
440 LF.

RECEIVED

MAR 30 2011

COLUMBIA RIVER GORGE COMM.

RECEIVED

MAR 30 2011

COLUMBIA RIVER GORGE COMM.



4.5XCNN36 with a gate

This model of fence fits perfectly into the design of this beautiful backyard swimming pool. Mom can easily exit (or enter) the pool area through our self closing gate while holding her daughter in on arm! It doesn't get any easier than that! This fence is 4.5 feet tall. Image 3 of 12

CLOSE X