

PO Box 730 • #1 Town & Country Square • White Salmon, Washington 98672 • 509-493-3323 • fax 509-493-2229  
[www.gorgecommission.org](http://www.gorgecommission.org)

## COLUMBIA RIVER GORGE COMMISSION

### NOTICE OF DEVELOPMENT REVIEW

This notice serves as an opportunity to comment on the application described below.

- Proposal:** The Columbia River Gorge Commission has received an application from Robert Hansen to install a 53'2" x 6'8" x 7' free-standing, ground-mounted, solar panel array and buried electric line to serve the residential energy needs of his property.
- Location:** The subject parcel is located on McConiga Road, (between Old highway 8 and State Route 14) and is located in the NE 1/4 of Section 33, Township 3 North, Range 12 East, W.M., Klickitat County, Washington (Klickitat County Parcel Number 03-12-3353-0005/00).
- Case File:** C10-0012-K-G-11
- Zoning:** The subject parcel is designated GMA Residential and is 6 acres in size.
- Comment Deadline:** The deadline for submitting public comment on the proposal is October 19, 2010.

The application and supporting documents are available for review at the Commission's office at #1 Town & Country Square (next to the White Salmon library), White Salmon, 8:00 a.m. to 5:00 p.m., Monday through Friday, (509) 493-3323. Additional information is available on our website at [www.gorgecommission.org](http://www.gorgecommission.org) under For Public Comment.

Comments may be mailed to the Commission's office, P.O. Box 730, White Salmon, WA 98672. Comments received are a matter of public record and are made available to the applicant. Comments may also be submitted by email to [info@gorgecommission.org](mailto:info@gorgecommission.org).

This application will be reviewed for consistency with the applicable portions of the Land Use Ordinance adopted by the Columbia River Gorge Commission (Commission Rule 350-81). The application is also subject to review for consistency with the Columbia River Gorge National Scenic Area Act (P.L. 99-663) and Management Plan. Consistency with the National Scenic Area Act does not imply nor ensure compliance with all other applicable local, state, and federal laws.

The Executive Director is scheduled to make a decision on the request by December 8, 2010.

  
Principal Planner

9-28-10

Date

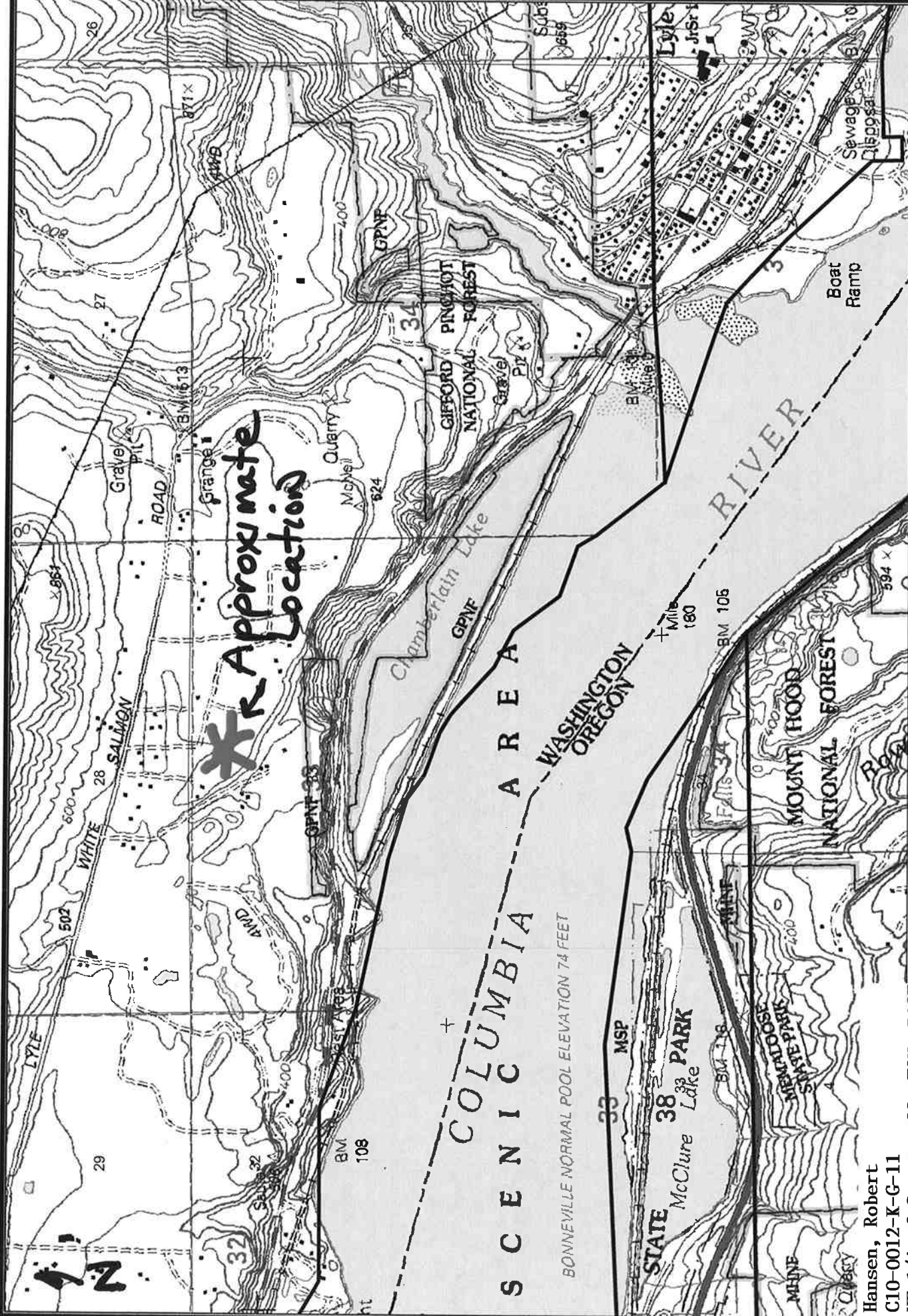

**X** Approximate Location

**SCENIC COLUMBIA AREA**

BONNEVILLE NORMAL POOL ELEVATION 74 FEET

Hansen, Robert  
 C10-0012-K-G-11  
 NE 1/4 of Section 33, T3N, R12E

Created by:

Date:

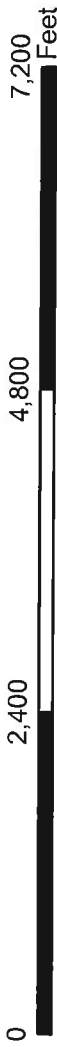

Disclaimer: The Columbia River Gorge National Scenic Area Columbia River Gorge Commission data, information, and maps are provided "as is" without warranty or any representation of accuracy, timeliness or completeness. This information is intended for general planning purposes and is not intended for site specific planning or analysis. Original data was compiled from various sources and that all information should be verified with those sources. Spatial information may not meet National Map Accuracy Standards. The requester acknowledges and accepts all limitations, including the fact that the data, information, and maps are dynamic and in a constant state of maintenance, correction and update.