

COLUMBIA RIVER GORGE COMMISSION

NOTICE OF DEVELOPMENT REVIEW

This notice serves as an opportunity to comment on the application described below.

Proposal: The Columbia River Gorge Commission has received an application from John and Deanna Nickols to construct a 8' x 20' tool shed and an 8' x 8' covered front porch. Construction of the shed and porch began prior to submittal of this application. Construction has been temporarily halted.

Location: The subject parcel is located south of County Road 1230 in the SW 1/4 of Section 28, Township 3 North, Range 12 East, W.M., Klickitat County, Washington.

Case File: C09-0006-K-G-11

Zoning: The subject parcel is designated Residential and is 9 acres in size.

Comment

Deadline: The deadline for submitting public comment on the proposal is May 13, 2009.

The application and supporting documents are available for review at the Commission's office at #1 Town & Country Square (next to the White Salmon library), White Salmon, 8:00 a.m. to 5:00 p.m., Monday through Friday, (509) 493-3323. Additional information is available on our website at www.gorgecommission.org under For Public Comment.

Comments may be mailed to the Commission's office, P.O. Box 730, White Salmon, WA 98672. Comments received are a matter of public record and are made available to the applicant. Comments may also be submitted by email to info@gorgecommission.org.

This application will be reviewed for consistency with the applicable portions of the Land Use Ordinance adopted by the Columbia River Gorge Commission (Commission Rule 350-81). The application is also subject to review for consistency with the Columbia River Gorge National Scenic Area Act (P.L. 99-663) and Management Plan. Consistency with the National Scenic Area Act does not imply nor ensure compliance with all other applicable local, state, and federal laws.

The Executive Director is scheduled to make a decision on the request by July 3, 2009.

Brian Litch

Planning Manager

4-22-09

Date

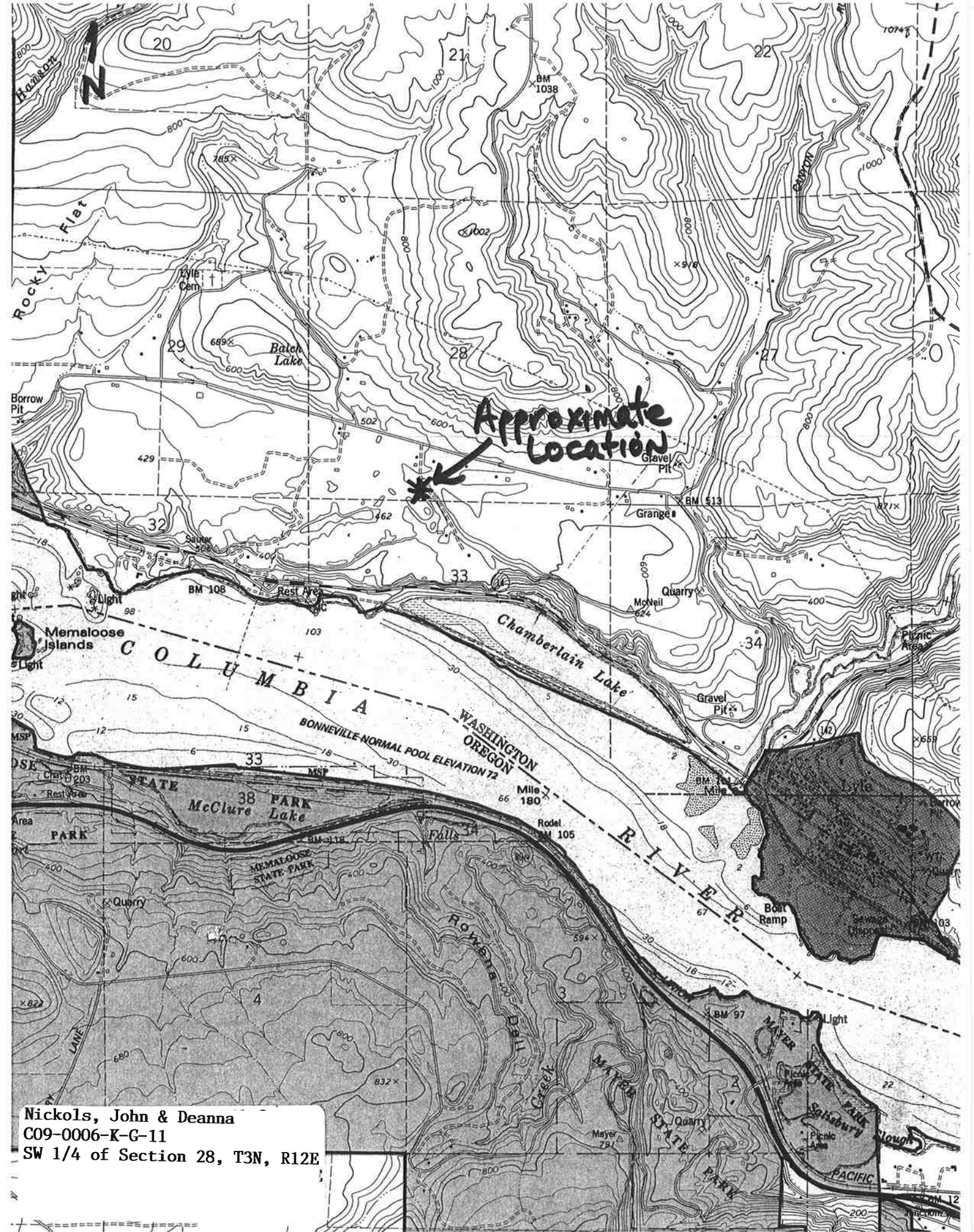

Approximate
Location

Nickols, John & Deanna
C09-0006-K-G-11
SW 1/4 of Section 28, T3N, R12E