

Columbia River Gorge Commission

#1 Town & Country Square • PO Box 730 • White Salmon WA 98672 • 509-493-3323

Land Use Application

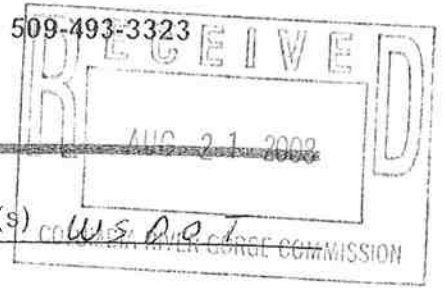

Applicant(s) WSDOT

Property Owner(s) WSDOT

Mailing Address P.O. Box 1709

Mailing Address ← same

Vancouver, WA 98668-1709

Phone H 360-905-2115

Phone H ← same

W/cell

W/cell

Location of property:

Township 3 N Range 10 E Street Address

Section & Qtr Section 14 NE 14 County Klickitat

Tax Lot No(s). 03101400009900 Parcel Size (acres) 64.95

Existing development and use of parcel

Hwy 141 Alt. NB milepost 5.07

Proposed use and/or development:

on Hwy 141 Alt sign for Tourist Activities
Rural Residential 2 & Resource Lands

Use of Adjacent Parcels

Parcels information included

Signature of the property owner(s) indicates that the property owner(s) is/are aware that an application is being made on the subject property. **Signature of the property owner(s) also authorizes the Gorge Commission or the Commission's designee(s) reasonable access to the site in order to evaluate the application.**

Applicant(s) signature Curtis D. Groff

date 6-25-08

date

Property owner(s) signature

date

date

Application checklist: The following is required to complete your application.

- Application form completed and signed
- Project description
- Site plan
- Elevation drawings
- Key viewing areas checklist
- Names and addresses of adjacent property owners
- Any additional information as required

Project description: Describe your proposed project including details on all uses proposed; the size, height, color, and construction materials of all structures; and any other details which explain how your proposal meets the requirements of the Scenic Area Land Use Ordinance.

Install sign on state R/W For Tourist
 Activities. 48" by 60" about 7' above the ground
 color Blue Background & white letters. Materials
 will be Alum. sign with reflective sign sheeling
 and square steel Posts. Posts & Back of
 sign will be Brown in color non reflective

within Hwy 141 ALT. R/w

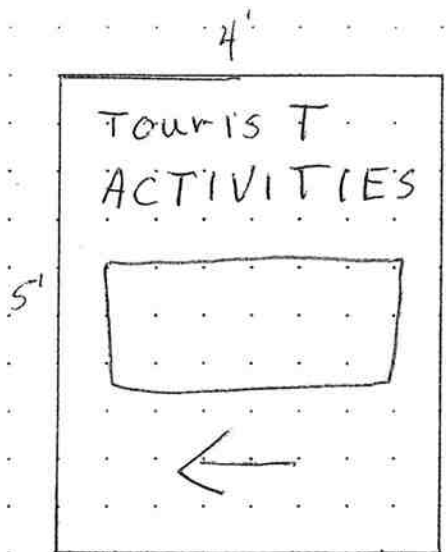

↑
7' plus or minus
↓

Ground.

Soil will be covered with straw for soil erosion issues if needed.

Each grid equals 50' x 50' at a scale of 1" = 200'.



Klickitat County Public Works

Refresh Map

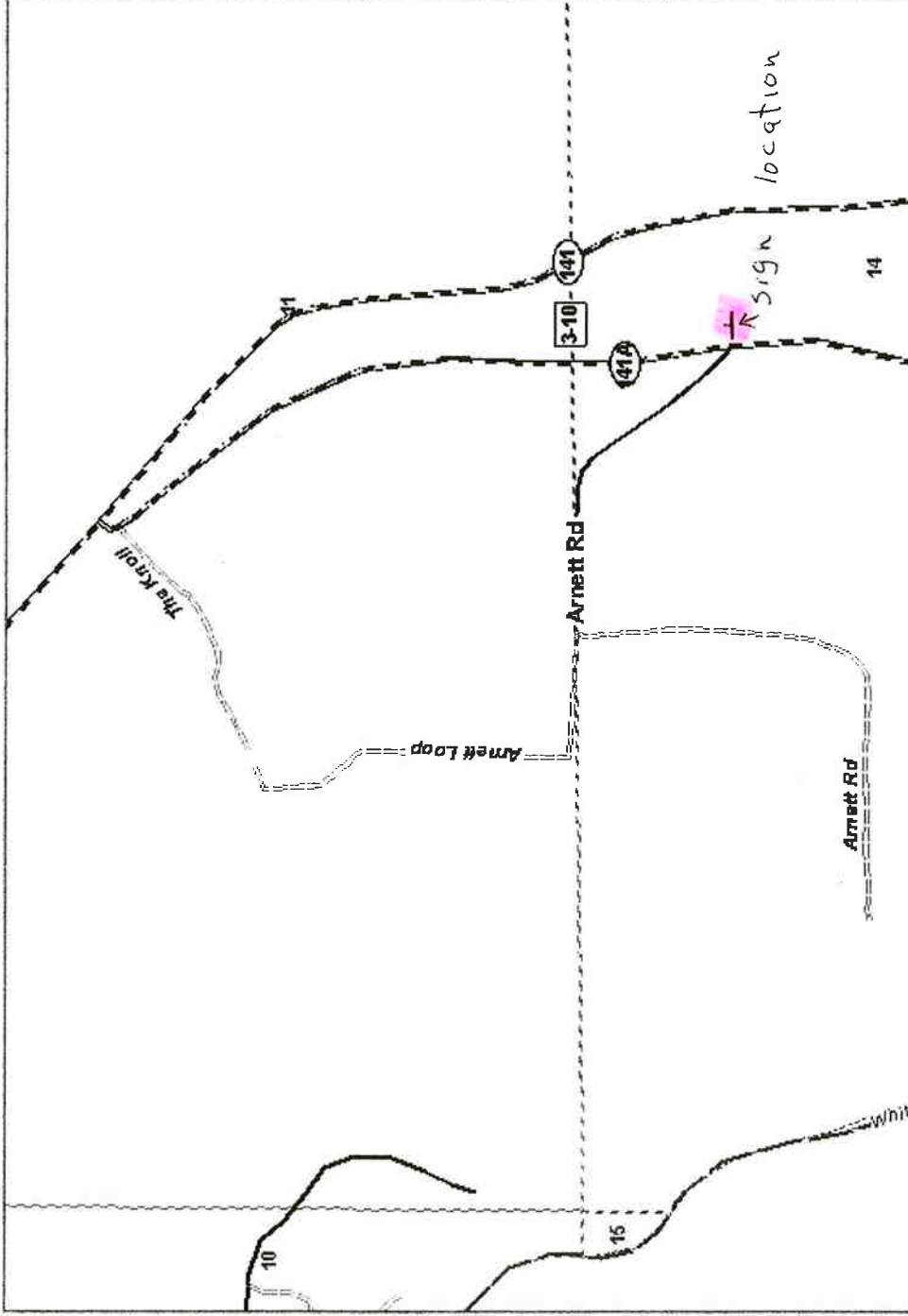

Sign will be located at Arnett Rd northbound on SR 141 Alt.

Layers

- ON ACTIVE
- Roads
- Hydrology
- Sections
- P-numbers
- Parcels
- Twp_Rge
- City Limits
- towns
- Transmission
- Pipeline
- Railroad
- Zoning
- comm_dist
- cemetery
- dog_ord
- firedist
- herd_law
- school_dist
- precincts
- rec_dist
- 2006 PHOTO (communities included)
- Topo Map

Zoom In

This map is for planning purposes only. Parcels are a graphical representation, use surveys & deeds of record for accurate data. Right of way is preliminary, refer to appropriate agency for status. Survey references may not be a complete list, check individual surveys for other documents. Verify