

PO Box 730 • #1 Town & Country Square • White Salmon, Washington 98672 • 509-493-3323 • fax 509-493-2229
www.gorgecommission.org

COLUMBIA RIVER GORGE COMMISSION

NOTICE OF DEVELOPMENT REVIEW

This notice serves as an opportunity to comment on the application described below.

Proposal: The Columbia River Gorge Commission has received an application from Verizon Wireless, representing Schreiner Farms, Inc., to install a wireless communication facility.

Location: The subject parcel is located northwest of Murdock, Washington in the NE 1/4 of Section 8, Township 2 North, Range 13 East, W.M., Klickitat County, Washington.

Case File: C08-0003-K-G-21

Zoning: The subject property is designated Large-Scale Agriculture and is approximately 496 acres in size.

Comment

Deadline: The deadline for submitting public comment on the proposal is May 26, 2008.

The application and supporting documents are available for review at the Commission's office at #1 Town & Country Square (next to the White Salmon library), White Salmon, 8:00 a.m. to 5:00 p.m., Monday through Friday, (509) 493-3323. Additional information is available on our website at www.gorgecommission.org under For Public Comment.

Comments may be mailed to the Commission's office, P.O. Box 730, White Salmon, WA 98672. Comments received are a matter of public record and are made available to the applicant. Comments may also be submitted by email to info@gorgecommission.org.

This application will be reviewed for consistency with the applicable portions of the Land Use Ordinance adopted by the Columbia River Gorge Commission (Commission Rule 350-81). The application is also subject to review for consistency with the Columbia River Gorge National Scenic Area Act (P.L. 99-663) and Management Plan. Consistency with the National Scenic Area Act does not imply nor ensure compliance with all other applicable local, state, and federal laws.

The Executive Director is scheduled to make a decision on the request by July 16, 2008.

Brian Hill

Planning Manager

5-5-08

Date

11N

NSA Boundary

B I A

3 4 5

10

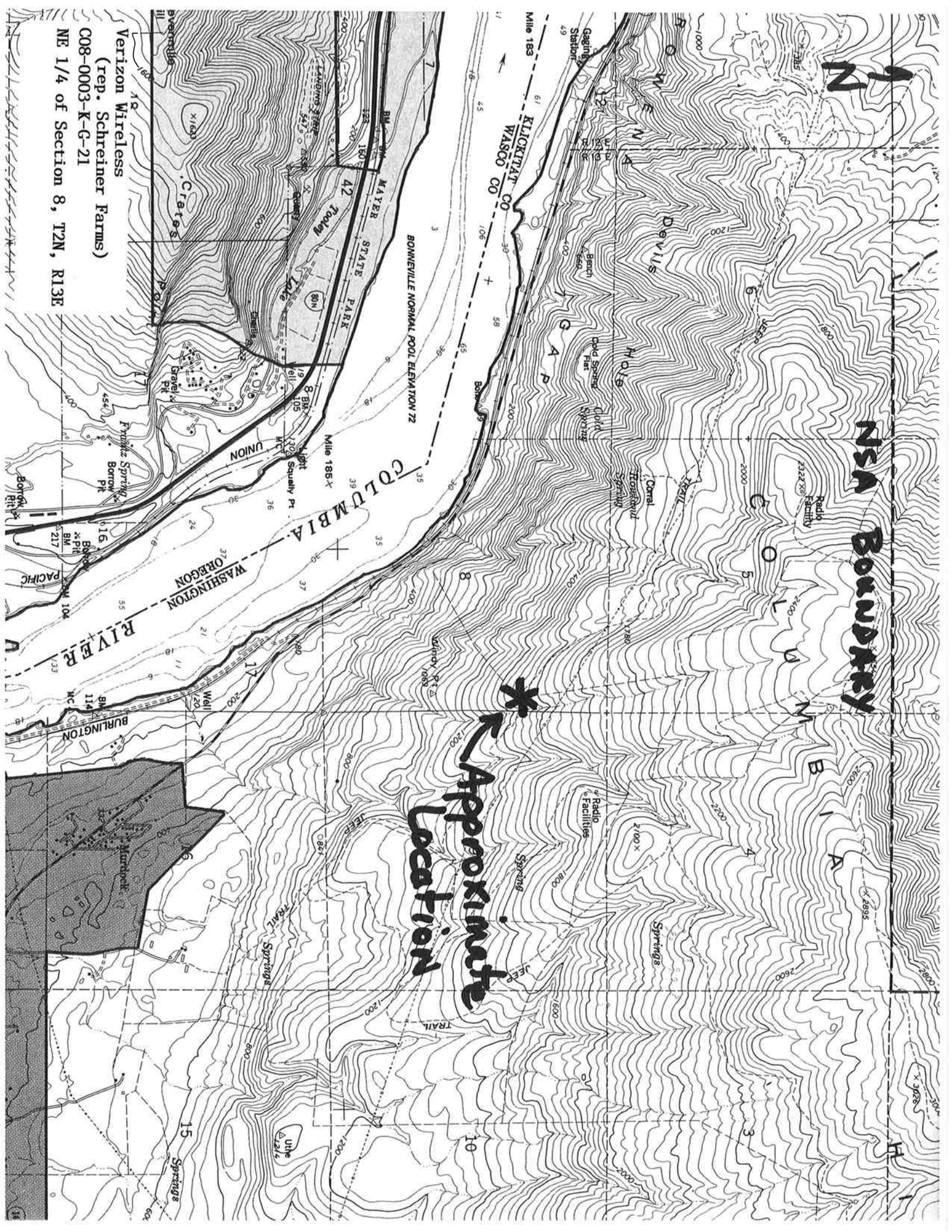

* Approximate Location

Verizon Wireless
 (rep. Schreiner Farms)
 C08-0003-K-G-21
 NE 1/4 of Section 8, T2N, R13E